

Well dimensions are absolute min. plumbed dimensions

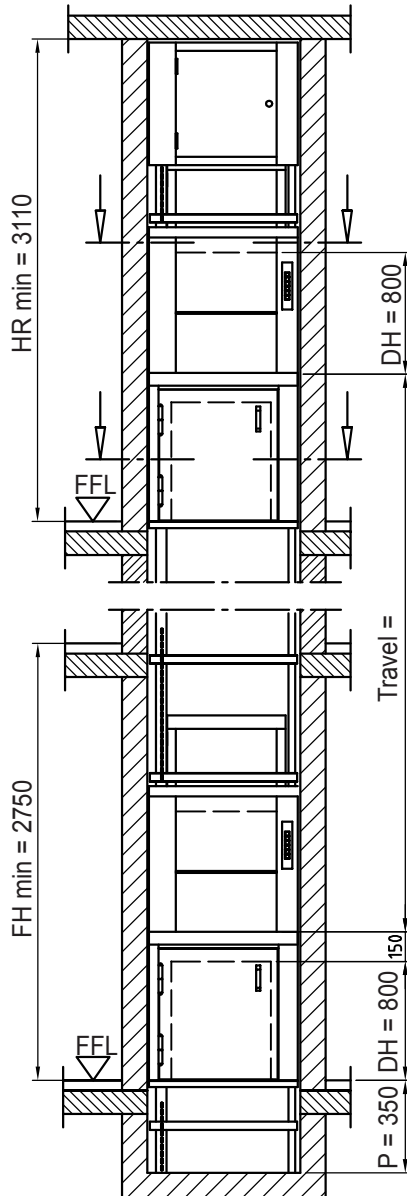

All doors drawn left hinged
Doors right hinged mirror-image

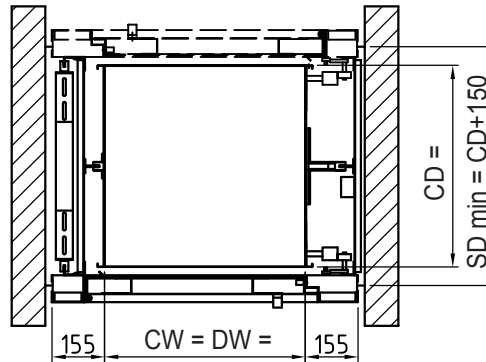
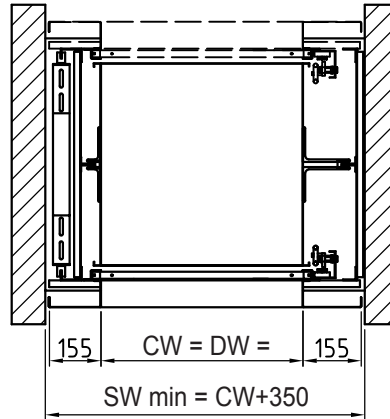

↑
machine room access

ATTENTION:

Cabin protection reduces clear entrance openings resp. shaft sizes (see part 10)

Shaft floor to be constructed according to layout drawing

Cabin width and -depth available in increments of 50 mm
Cabin height available in increments of 100 mm

- | | | |
|-----|------------------------|---|
| CW | = cabin width | min. 600 - max. 1000 mm |
| CD | = cabin depth | min. 700 - max. 1000 mm |
| CH | = cabin height | 1750 - 2000 mm (1750 standard dimension) |
| DW | = door width | = Cabin width |
| DH | = door height | = 800 mm each compartment |
| P | = pit | = min. 350 mm |
| SW | = Shaft width | = plumbed min. dimensions |
| SD | = Shaft depth | = plumbed min. dimensions |
| HR | = Headroom | = clear height of top floor FFL - underside ceiling |
| FFL | = finished floor level | |



Prices and specification see back side